

Panasonic

CD Stereo System

Operating Instructions



The illustrations show SC-EN5.

Model No. **SC-EN5**
SC-EN53

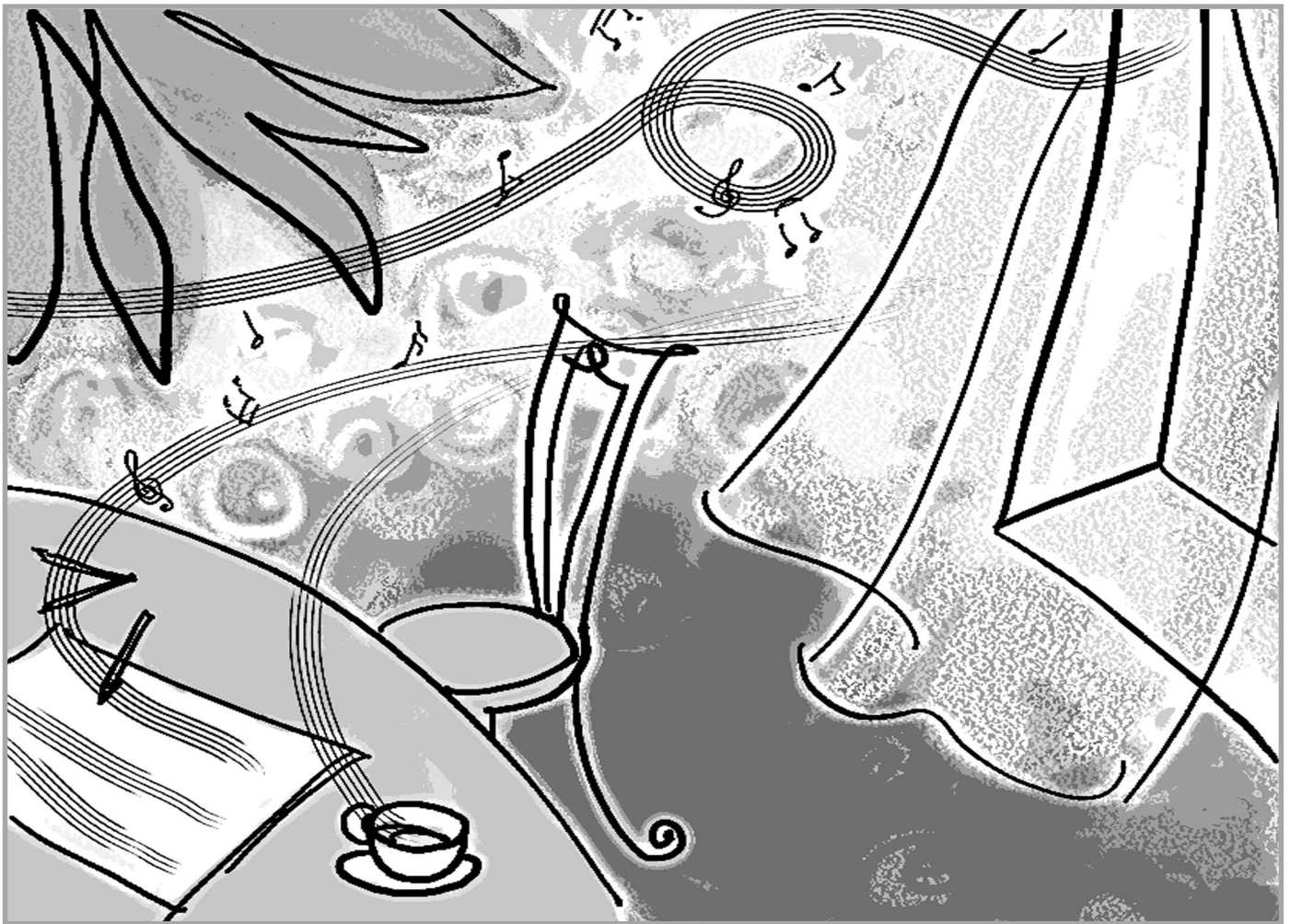

COMPACT
disc
DIGITAL AUDIO

Before connecting, operating or adjusting this product, please read these instructions completely.
Please keep this manual for future reference.

Dear customer

Thank you for purchasing this product.
For optimum performance and safety, please read these instructions carefully.

These instructions are applicable to the SC-EN5 and SC-EN53 stereo systems and the supplied RAPX0042 speakers.

The model number and serial number of this product can be found on either the back or the bottom of the unit.
Please note them in the space provided below and keep for future reference.

MODEL NUMBER _____
SERIAL NUMBER _____

User memo:

DATE OF PURCHASE _____
DEALER NAME _____
DEALER ADDRESS _____

TELEPHONE NUMBER _____

CAUTION!

THIS PRODUCT UTILIZES A LASER.
USE OF CONTROLS OR ADJUSTMENTS OR PERFORMANCE OF PROCEDURES OTHER THAN THOSE SPECIFIED HEREIN MAY RESULT IN HAZARDOUS RADIATION EXPOSURE.
DO NOT OPEN COVERS AND DO NOT REPAIR YOURSELF.
REFER SERVICING TO QUALIFIED PERSONNEL.

WARNING:

TO REDUCE THE RISK OF FIRE, ELECTRIC SHOCK OR PRODUCT DAMAGE, DO NOT EXPOSE THIS APPARATUS TO RAIN, MOISTURE, DRIPPING OR SPLASHING AND THAT NO OBJECTS FILLED WITH LIQUIDS, SUCH AS VASES, SHALL BE PLACED ON THE APPARATUS.

CAUTION:

TO PREVENT ELECTRIC SHOCK MATCH WIDE BLADE OF PLUG TO WIDE SLOT, FULLY INSERT.

CAUTION!

DO NOT INSTALL OR PLACE THIS UNIT IN A BOOKCASE, BUILT-IN CABINET OR IN ANOTHER CONFINED SPACE. ENSURE THE UNIT IS WELL VENTILATED. TO PREVENT RISK OF ELECTRIC SHOCK OR FIRE HAZARD DUE TO OVERHEATING, ENSURE THAT CURTAINS AND ANY OTHER MATERIALS DO NOT OBSTRUCT THE VENTILATION VENTS.

Supplied accessories	3
Listening caution	3
IMPORTANT SAFETY INSTRUCTIONS	4
The remote control	5
Placement of speakers	5
Set-up	6
Front panel controls	7
CDs	8
The radio: manual tuning	10
The radio: preset tuning	10
Sound quality	11
External unit connections	11
Using an external unit	11
Using headphones (not included)	11
Setting the time	11
Using the timers	12
Troubleshooting guide	13
Maintenance	13
Limited Warranty (ONLY FOR U.S.A.)	14
Customer Services Directory (ONLY FOR U.S.A.)	14
Specifications	15
Product Service	15

For Canada only

CAUTION	INVISIBLE LASER RADIATION WHEN OPEN AND INTERLOCKS DEFEATED. AVOID EXPOSURE TO BEAM. (IEC 60825-1:0 Class 3b)
ATTENTION	RAYONNEMENT LASER INVISIBLE DANGEREUX EN CAS D'OUVERTURE ET LORSQUE LA SECURITE EST NEUTRALISEE. EXPOSITION DANGEREUSE AU FAISCEAU.
ADVARSEL	USYNLIG LASERSTRÅLING VED ÅBNING. NÅR SIKKERHEDSÅFSPRØDEDE ER UDE AF FUNKTION, UNDGÅ UDSÆTTELSE FOR STRÅLING.
VARO!	AVIATTAESSA, JÄ SUOJALUKITUS OHTETTAESSA OLET ALLTIINA NÄKYMÄTÖNÄ LASERSÄTELYLLE. ÄLÄ KATSO SÄTEESEEN.
VARNING	OSYNLIG LASERSTRÅLNING NÄR DENNA DEL ÄR ÖPPNAD OCH SPÄRREN ÄR URKOPPLAD. BETRÄKTA EJ STRÅLEN.
VORSICHT	UNSICHTBARE LASERSTRALUNG. WENN ABDECKUNG GEÖFFNET UND SICHERHEITSVERPREGELUNG ÜBERBRÜCKT, NICHT DEM STRAHL AUSSETZEN.
ADVARSEL	USYNLIG LASERSTRÅLING NÅR DEKSEL ÅPNES OG SIKKERHEDSLÅS BRYTES. UNNGÅ EKSPONERING FOR STRÅLEN. (IOLXSD0053)

Inside of product

Supplied accessories



Please check and identify the supplied accessories. Use numbers indicated in parentheses when asking for replacement parts.

(Only for U.S.A.)

To order accessories contact 1-800-332-5368 or web site (<http://www.panasonic.com>).

Remote control transmitter 1 pc.
(EUR7101010)

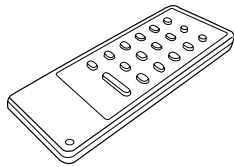

AC adaptor 1 pc.
(RFEA201C-T)

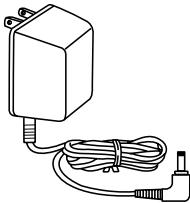

AM loop antenna 1 pc.
(G0ZZ00002036)

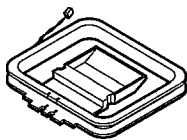

Battery 1 pc.
CR 2032



Listening caution



Selecting fine audio equipment such as the unit you've just purchased is only the start of your musical enjoyment. Now it's time to consider how you can maximize the fun and excitement your equipment offers. This manufacturer and the Electronic Industries Association's Consumer Electronics Group want you to get the most out of your equipment by playing it at a safe level. One that lets the sound come through loud and clear without annoying blaring or distortion—and, most importantly, without affecting your sensitive hearing.

We recommend that you avoid prolonged exposure to excessive noise.

Sound can be deceiving. Over time your hearing "comfort level" adapts to higher volumes of sound. So what sounds "normal" can actually be loud and harmful to your hearing.

Guard against this by setting your equipment at a safe level BEFORE your hearing adapts.

To establish a safe level:

- Start your volume control at a low setting.
- Slowly increase the sound until you can hear it comfortably and clearly, and without distortion.

Once you have established a comfortable sound level:

- Set the dial and leave it there.

Taking a minute to do this now will help to prevent hearing damage or loss in the future. After all, we want you listening for a lifetime.

THE FOLLOWING APPLIES ONLY IN THE U.S.A.:

CAUTION:

This equipment has been tested and found to comply with the limits for a Class B digital device, pursuant to Part 15 of the FCC Rules.

These limits are designed to provide reasonable protection against harmful interference in a residential installation. This equipment generates, uses and can radiate radio frequency energy and, if not installed and used in accordance with the instructions, may cause harmful interference to radio communications. However, there is no guarantee that interference will not occur in a particular installation. If this equipment does cause harmful interference to radio or television reception, which can be determined by turning the equipment off and on, the user is encouraged to try to correct the interference by one or more of the following measures:

- Reorient or relocate the receiving antenna.
- Increase the separation between the equipment and receiver.
- Connect the equipment into an outlet on a circuit different from that to which the receiver is connected.
- Consult the dealer or an experienced radio/TV technician for help.

Any unauthorized changes or modifications to this equipment would void the user's authority to operate this device.

This device complies with Part 15 of the FCC Rules. Operation is subject to the following two conditions: (1) This device may not cause harmful interference, and (2) this device must accept any interference received, including interference that may cause undesired operation.

IMPORTANT SAFETY INSTRUCTIONS

Read these operating instructions carefully before using the unit. Follow the safety instructions on the unit and the applicable safety instructions listed below. Keep these operating instructions handy for future reference.

- 1) Read these instructions.
- 2) Keep these instructions.
- 3) Heed all warnings.
- 4) Follow all instructions.
- 5) Do not use this apparatus near water.
- 6) Clean only with dry cloth.
- 7) Do not block any ventilation openings. Install in accordance with the manufacturer's instructions.
- 8) Do not install near any heat sources such as radiators, heat registers, stoves, or other apparatus (including amplifiers) that produce heat.
- 9) Do not defeat the safety purpose of the polarized or grounding-type plug. A polarized plug has two blades with one wider than the other. A grounding-type plug has two blades and a third grounding prong. The wide blade or the third prong are provided for your safety. If the provided plug does not fit into your outlet, consult an electrician for replacement of the obsolete outlet.
- 10) Protect the power cord from being walked on or pinched particularly at plugs, convenience receptacles, and the point where they exit from the apparatus.
- 11) Only use attachments/accessories specified by the manufacturer.
- 12) Use only with the cart, stand, tripod, bracket, or table specified by the manufacturer, or sold with the apparatus. When a cart is used, use caution when moving the cart/apparatus combination to avoid injury from tip-over. 
- 13) Unplug this apparatus during lightning storms or when unused for long periods of time.
- 14) Refer all servicing to qualified service personnel. Servicing is required when the apparatus has been damaged in any way, such as power-supply cord or plug is damaged, liquid has been spilled or objects have fallen into the apparatus, the apparatus has been exposed to rain or moisture, does not operate normally, or has been dropped.

The remote control

Batteries

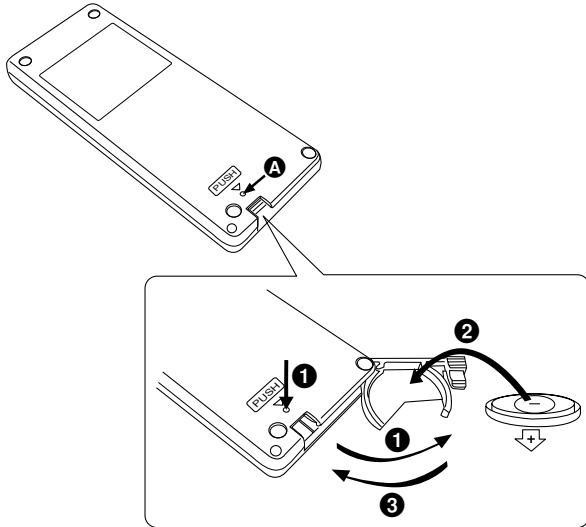

- The battery holder of this remote control comes with a safety lock. To open, use a pin (not included) or similar object to push into hole **A** and pull out the battery holder.
- Insert the battery with the positive (+) side facing down.
- Do not use rechargeable type batteries.

CAUTION:

The battery used in this device may present a risk of fire or chemical burn if mistreated. Do not recharge, disassemble, heat above 100°C (212°F), or incinerate. Replace battery with Panasonic part number CR 2032 only. Use of another battery may present a risk of fire or explosion.

Dispose of used battery promptly. Keep away from children. Do not disassemble and do not dispose of in fire.

Use

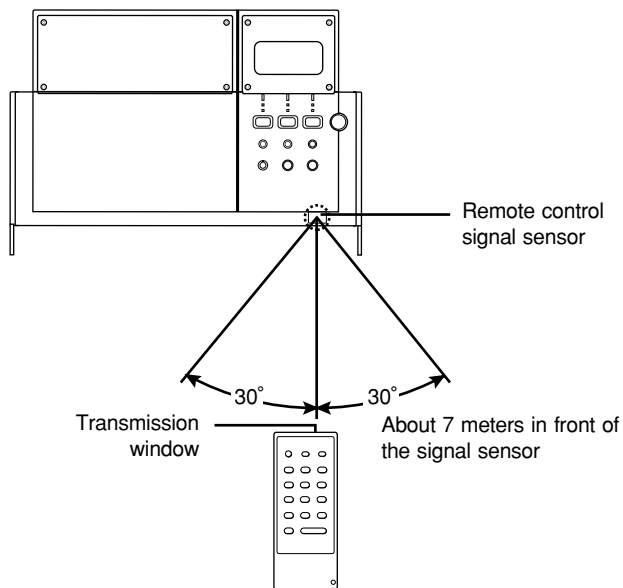

Aim at the sensor, avoiding obstacles, at a maximum range of 7 meters directly in front of the unit.

- Keep the transmission window and the unit's sensor free from dust.
- Operation can be affected by strong light sources, such as direct sunlight, and the glass doors on cabinets.

Do not:

- put heavy objects on the remote control.
- take the remote control apart.
- spill liquids onto the remote control.

Placement of speakers

Speakers are designed identically so that no left or right channel orientation is necessary.

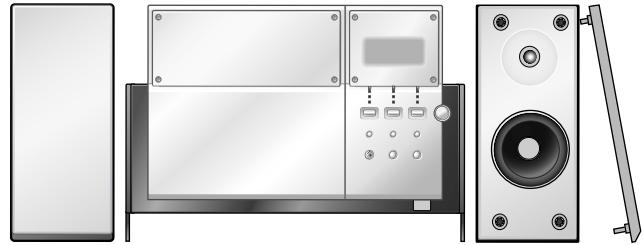

Notes

- Keep your speakers at least 10 mm ($13/32$ ") away from the system for proper ventilation.
- These speakers do not have magnetic shielding. Do not place them near televisions, personal computers or other devices easily influenced by magnetism.
- To avoid damage to the speakers, do not touch the speaker cones if you have taken the nets off.



Caution

- Use the speakers only with the recommended system. Failure to do so may lead to damage to the amplifier and/or the speakers, and may result in the risk of fire. Consult a qualified service person if damage has occurred or if you experience a sudden change in performance.
- Do not attach these speakers to walls or ceilings.

Set-up

Connect the AC adaptor only after all other connections have been made.

Preparation

Twist and pull off the vinyl tip of the speaker cords.



1 AM loop antenna

Stand the antenna up on its base.

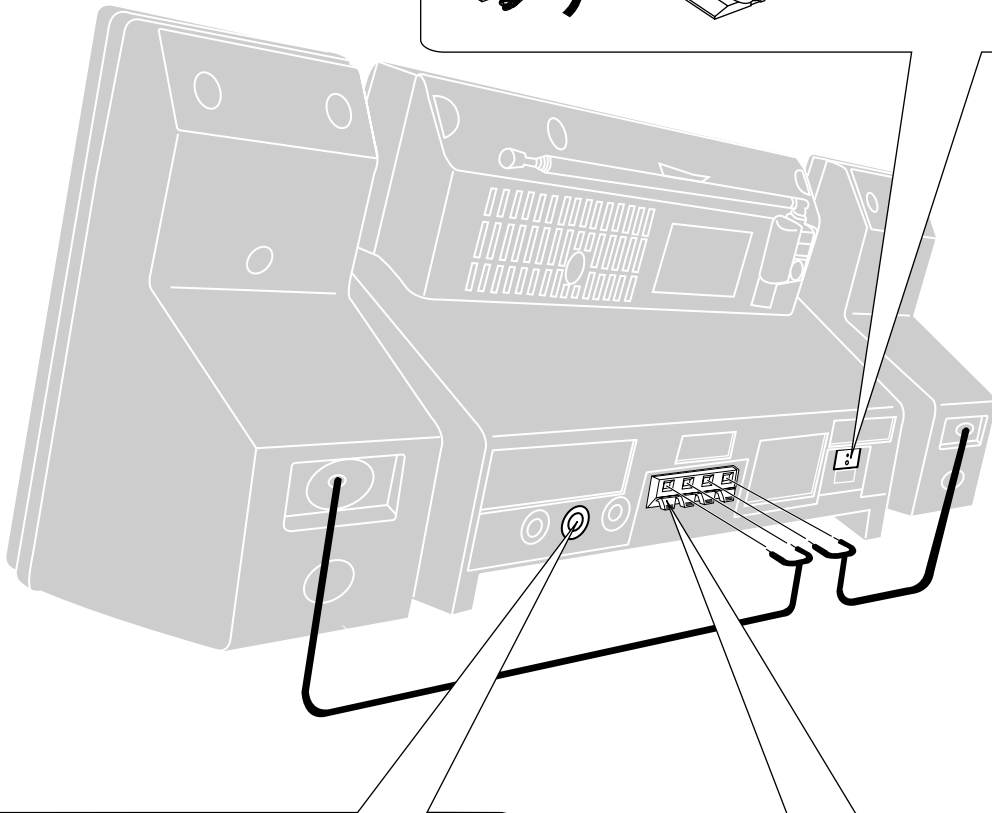
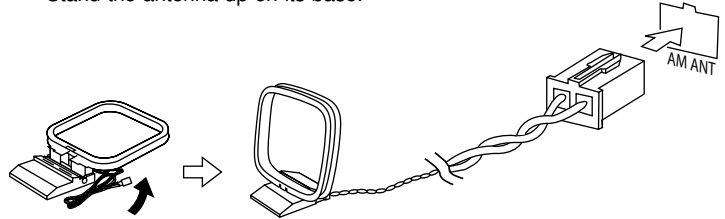

3 AC adaptor

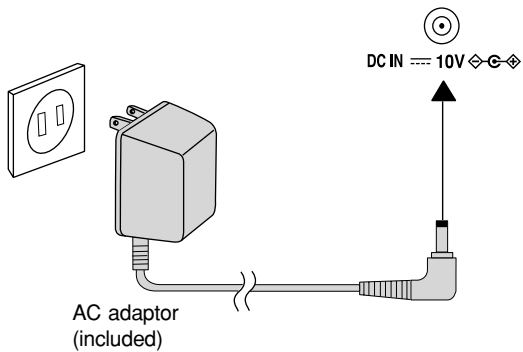

Note

- The configuration of the AC adaptor differs according to the area.

2 Speaker cords

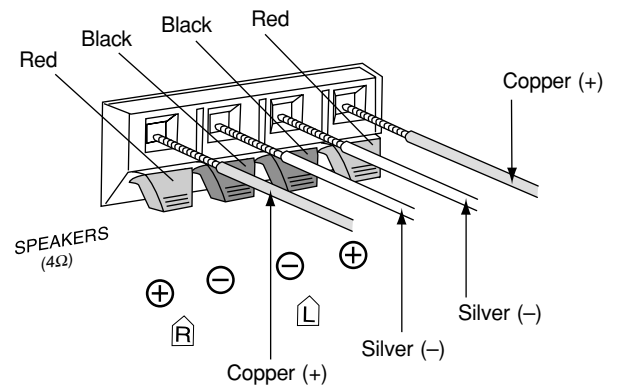

Use only the supplied speakers.

The combination of the main unit and speakers provide the best sound. Using other speakers can damage the unit and sound quality will be negatively affected.

Front panel controls

Main unit

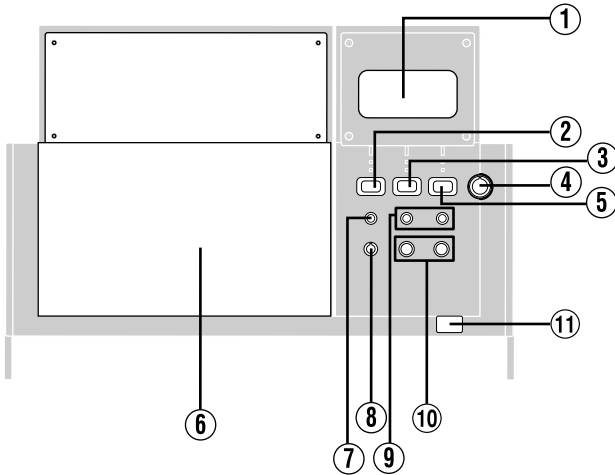

- ① Display
- ② AUX button (AUX) 11
- ③ Tuner/band select button (TUNER/BAND) 10
- ④ CD stop, CD lid open/close button (■/▲) 8
- ⑤ CD play/pause button (CD ▶/||) 8
- ⑥ CD lid
- ⑦ Tuning mode select button (TUNING MODE) 10
- ⑧ Standby/on switch (POWER ⏻/⏻)
- Press to switch the unit from on to standby mode or vice versa. In standby mode, the unit is still consuming a small amount of power.
- This button also functions as standby indicator.
- When the unit is in standby mode: the indicator lights up.
- When the unit is on: the indicator goes out.
- ⑨ CD skip/search, tune/preset channel select, time adjust buttons (◀◀/-, +/▶▶) 8, 10, 11
- ⑩ Volume control (VOLUME, -, +) 8
- ⑪ Remote control signal sensor 5

Remote control

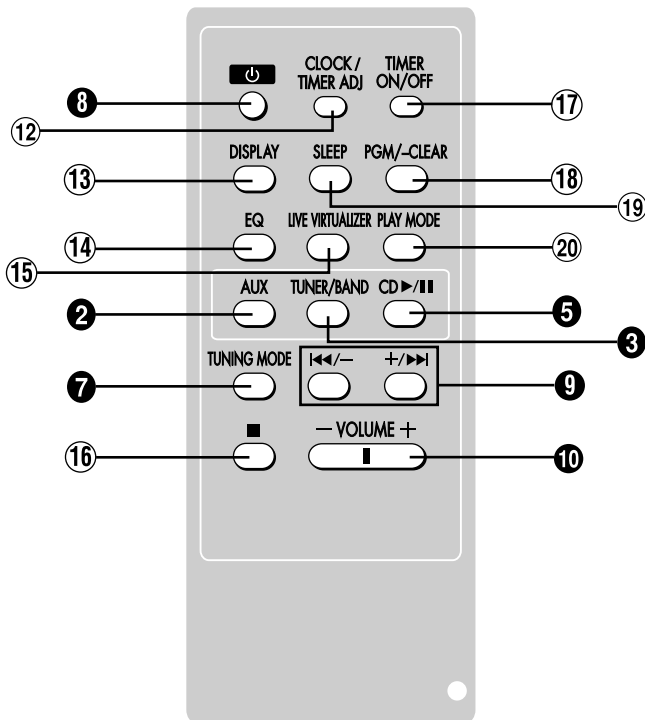

Buttons such as ③ function in exactly the same way as the buttons on the main unit.

- ⑫ Clock/timer adjust button (CLOCK/TIMER ADJ) 11, 12
- ⑬ Display button (DISPLAY) 8
- ⑭ EQ select button (EQ) 11
- ⑮ Live virtualizer button (LIVE VIRTUALIZER) 11
- ⑯ CD stop button (■) 8
- ⑰ Timer on/off button (TIMER ON/OFF) 12
- ⑱ CD program/clear, tuner preset button (PGM/-CLEAR) 9, 10
- ⑲ Sleep timer button (SLEEP) 12
- ⑳ Play mode select button (PLAY MODE) 9

CD selection

Choose CDs with this mark:



Do not:

- use irregularly shaped CDs.
- attach extra labels and stickers.
- use CDs with labels and stickers that are coming off or with adhesive exuding from under labels and stickers.
- attach scratch proof covers or any other kind of accessory.
- write anything on the CD.
- clean CDs with liquids. (Wipe with a soft, dry cloth.)
- use CDs printed with label printers available on the market.

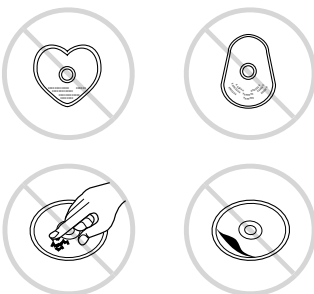

This unit can play CD-DA (digital audio) format audio CD-R and CD-RW that have been finalized (a process that enables CD-R/CD-RW players to play audio CD-R and CD-RW) upon completion of recording. It may not be able to play some CD-R or CD-RW due to the condition of the recording.

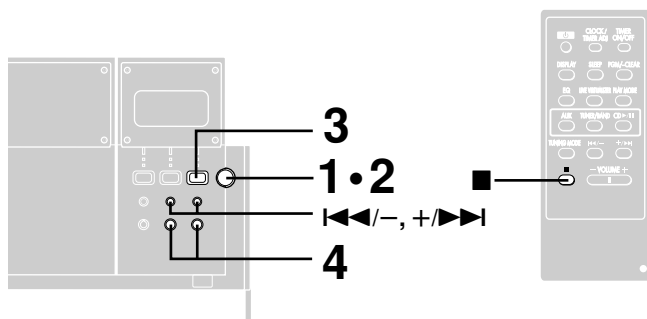

1 Press [■/▲] to open the CD lid.
The unit comes on. Ensure that the whip antenna does not block the CD lid when it is opening.

2 Load a CD with the label facing outward.
Press [■/▲] to close the CD lid.

Caution:
Keep fingers away from the CD lid when it is closing to avoid possible minor injury.

3 Press [CD ▶/||] to start play.
Plays to the end of the CD and stops.

4 Adjust the volume.

To stop the disc
Press [■/▲]. (remote control: [■]).

To pause play
Press [CD ▶/||]. Press [CD ▶/||] again to resume play.

Skipping tracks
Press [◀/−] (backward) or [+/▶▶] (forward).

Searching through tracks
During play or pause
Press and hold [◀/−] (backward) or [+/▶▶] (forward).

One touch play

When a CD is loaded and the unit is off, press [CD ▶/||]. The unit comes on and starts play.

Note

- During random play (⇒ page 9), you cannot skip to tracks which have already been played.
- During program play or random play (⇒ page 9), you cannot search forward or backward over tracks.
- During program play, skipping is always in the programmed order, whether forward or backward.
- Program play cannot be used in combination with random play.

Direct access play

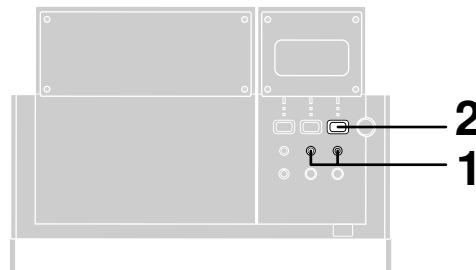

Direct access allows you to start normal play from a specific track to the last track of the CD.

Preparation:

Press [CD ▶/||] and then [■/▲].

- 1 Press [◀/−] or [+/▶▶] to select the desired track number.**
- 2 Press [CD ▶/||] to start play.**
Play will start with the track you select.

Repeat play and random play

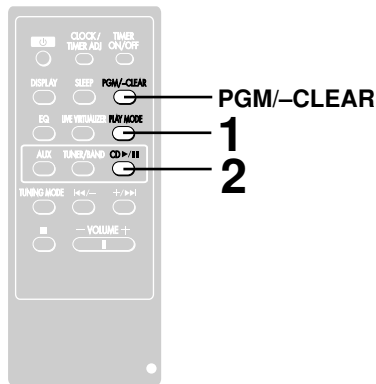

Remote control only

1 Press [PLAY MODE] before play to select the desired play mode.

Every time you press the button:

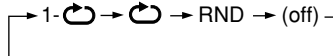

To repeat just one track:

Press [PLAY MODE] to select “1-”.

To repeat all tracks:

Press [PLAY MODE] to select “”.

To start random play:

Press [PLAY MODE] to select “RND”.

All tracks on the loaded CD will be played in random order.

Playback will stop automatically when all tracks have been played.

2 Press [CD >||] to start play.

To cancel repeat play and random play

Press [PLAY MODE] to select “(off)” during stop, as shown in the illustration in step 1 above.

Repeat play and random play will also be cancelled by opening the CD lid.

To repeat programmed tracks

- ① Program desired tracks (steps 1 to 5 on page 9).
- ② Press [PLAY MODE] to display “”.
- ③ Press [CD >||] to begin play.

Note

- You can also turn the repeat mode on/off during CD play.
- Random play does not work when “PGM” is displayed (press and hold [PGM/-CLEAR] first).
- Search can be done within the track in play only.

Program play

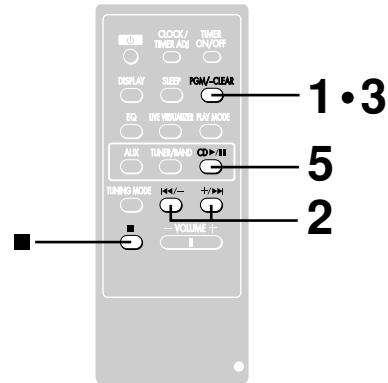

This function allows you to program up to 24 tracks.

Remote control only

Preparation: Press [CD >||] and then [■].

- 1 (In the stop mode)
Press [PGM/-CLEAR].
- 2 Press [◀◀/-] or [+/▶▶] to select the track you want to play in the desired sequence.
- 3 Press [PGM/-CLEAR] again.
- 4 Repeat steps 2 and 3 until you have programmed all the tracks you want.
- 5 Press [CD >||].

Play will start in the programmed sequence.

Play will stop automatically when all the programmed tracks have been played.

The program remains intact even if play is stopped or the unit is turned off. “P” appears when play is stopped to indicate the contents are in the memory.

To cancel program play mode

Press and hold [PGM/-CLEAR] in the stop mode until “CLEAR” is displayed.

The mode is also canceled if the CD tray is opened.

This will also erase the entire program.

A When “- :- -” is displayed

Total play time of the programmed tracks equals, or exceeds 250 minutes.

Tracks can still be programmed and played.

B When “PGM FULL” appears

The number of programmed tracks is limited to 24. No further tracks can be programmed.

C Check program contents

- ① Press [■].
“P” is displayed.
- ② Press [PGM/-CLEAR], then press either [◀◀/-] or [+/▶▶].
Every time you press one of the buttons, the track and program No. are shown on the display.

Add to the program

In the stop mode, repeat steps 2 and 3.

Note

- Program play does not work when “RND” is displayed (press [PLAY MODE] to clear it) (➡ page 9).
- Search can be done within tracks only.

The radio: manual tuning

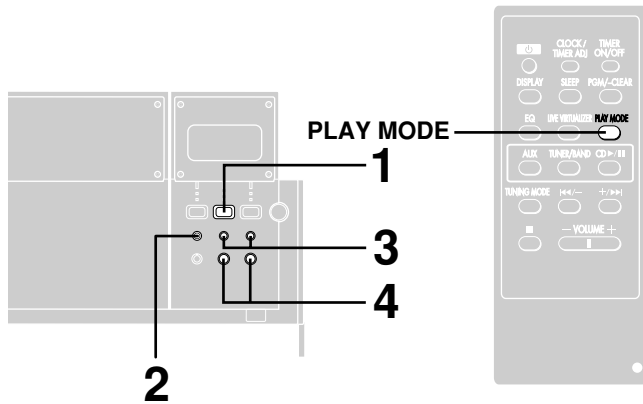

- 1 Press [TUNER/BAND] to select “FM” or “AM”.**
The unit comes on.
Every time you press the button:
FM ↔ AM
- 2 Press [TUNING MODE] to select “MANUAL”.**
Every time you press the button:
MANUAL ↔ PRESET
- 3 Press [◀◀/–] or [+/▶▶] to select the frequency of the required station.**
- 4 Adjust the volume.**

Auto tuning

Press and hold [◀◀/–] or [+/▶▶] for a moment until the frequency starts changing rapidly. The unit begins auto tuning, stopping when it finds a station.

- Auto tuning may not function when there is excessive interference.
- To cancel auto tuning, press [◀◀/–] or [+/▶▶] once again.

To improve reception

Extend the whip antenna and adjust its direction.

If noise is excessive in FM

Remote control only

Press [PLAY MODE] to display “MONO”.

This mode improves sound quality if reception is weak, but broadcasts will be heard in monaural.

Press [PLAY MODE] again to cancel the mode.

“MONO” goes out. MONO is also cancelled if the frequency is changed.

Turn off “MONO” for normal listening. Stereo and monaural broadcasts are automatically played as they are received.

FM allocation setting

Main unit only

By adjusting the allocation, you can enable this tuner to receive FM broadcasts allocated in 0.1 MHz steps.

Preparation:

Press [TUNER/BAND] to select “AM”.

Press and hold [TUNER/BAND]. After a few seconds, the display will change to a flashing display of the current minimum FM frequency. If you continue to hold the button down, the minimum frequency will change. Release the button at this time.

To return to the original frequency indication, repeat above.

Note

- After changing the “allocation” setting, the frequencies you previously preset in the memory will be cleared.

The radio: preset tuning

Up to 12 stations each can be set in the FM and AM bands.

Preparation:

Press [TUNER/BAND] to select “FM” or “AM”.

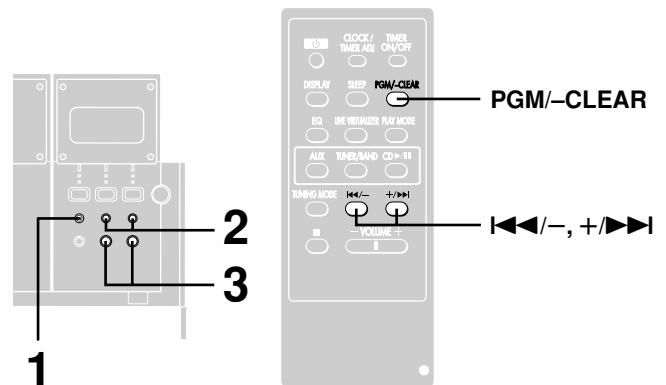

Manual pre-setting

Remote control only

Pre-set the stations one at a time.

- ① Press [PGM/–CLEAR] then press [◀◀/–] or [+/▶▶] to tune to the required station.
- ② Press [PGM/–CLEAR] then press [◀◀/–] or [+/▶▶] to select a channel.
- ③ Press [PGM/–CLEAR].

The station occupying a channel is erased if another station is preset in that channel.

Selecting channels

- 1 Press [TUNING MODE] to select “PRESET”.**
- 2 Press [◀◀/–] or [+/▶▶] to select the channel.**
- 3 Adjust the volume.**

Sound quality

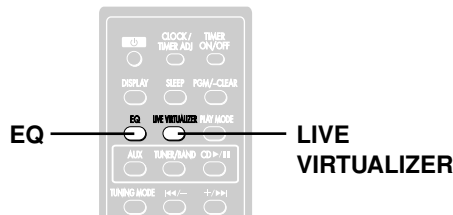

Using the built-in sound quality

You can choose one of four types of sound quality.

D.BASS: Adds punch to rock

CLEAR: Clarifies higher sounds

SOFT: For background music

VOCAL: Adds gloss to vocal

Remote control only

Press [EQ] to select a setting.

Every time you press the button:

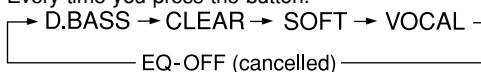

3-D sound with the Live Virtualizer

Remote control only

You can create a three-dimensional sound field when listening to stereo sound.

Press [LIVE VIRTUALIZER].

Press again to cancel.

Note

The actual effect depends on the source played.

External unit connections

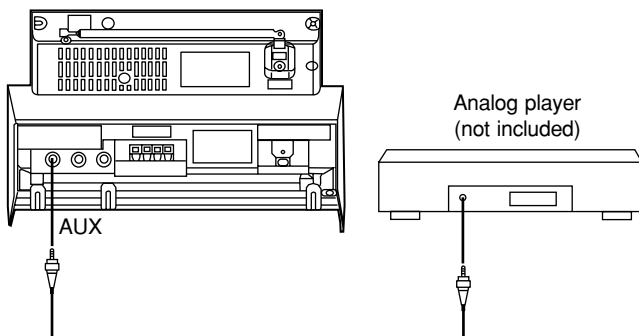

- An analog player with a built-in phono equalizer can be connected.
- For details, refer to the instruction manual of the units which are to be connected.
- When units other than those described above are to be connected, please consult your audio dealer.

Using an external unit

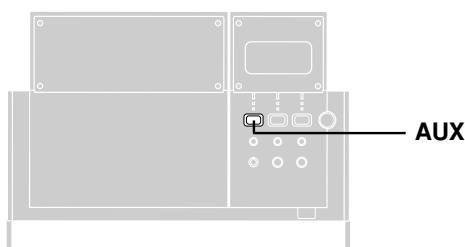

Listening to an external source

(See above for external unit connection)

1. Press [AUX].
The unit comes on.
2. Start playback from the external source. (For details, refer to the external unit's instruction manual.)

Using an external unit

You can boost up the "AUX" output level.

Press and hold [AUX].

Every time you press and hold the button:

NORMAL ↔ HIGH

NORMAL: Normal output signal level

(Use when external source's signal level is normal).

HIGH: To boost up to a higher output signal level

(Use when external source's signal level is low, for example portable CD/MD player).

Using headphones (not included)

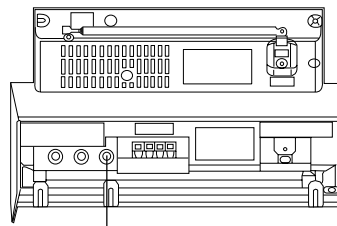

PHONES

Reduce the volume level and connect the headphones to the [PHONES] jack.

Plug type: 3.5 mm (1/8") stereo

Note

Avoid listening for prolonged periods of time to prevent hearing damage.

Setting the time

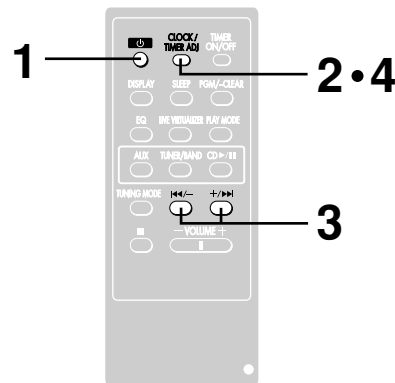

Remote control only

This is a 12-hour clock.

- 1 Press [⏻] to turn the unit on.
- 2 Press [CLOCK/TIMER ADJ] to select "CLOCK".
- 3 Within 10 seconds
Press [◀/−] or [+/▶] to set the time.
Press and hold to change the time faster.
- 4 Press [CLOCK/TIMER ADJ].
The time is set and the original display is restored.

To switch to clock display

Press [DISPLAY].

Every time you press the button:

Clock display ↔ Current display

Displaying the clock when the unit is ON:

Press [CLOCK/TIMER ADJ].

The clock is shown for about 10 seconds.

Note

The clock is accurate to within ±60 seconds a month.

Readjust if necessary.

Using the timers

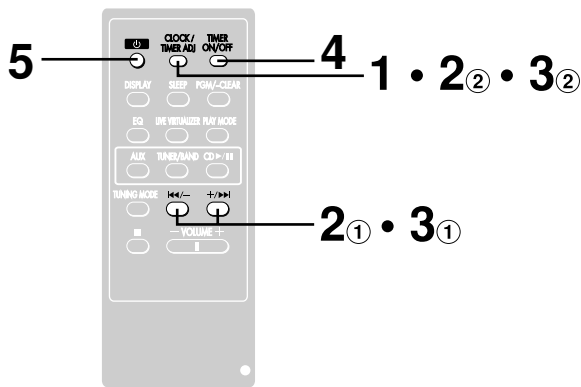

Using the play timer

Remote control only

The play timer can be set to on at a certain time to wake you up.

Preparations:

- Turn the unit on and set the clock (→ page 11).
- Prepare the music source you want to listen to: CD, radio or aux, and set the volume.

1 Press [CLOCK/TIMER ADJ] to select the timer function.

Every time you press the button:

CLOCK → ON TIME → OFF TIME
 ↑ Previous display ↓

ON TIME: to set the start time

OFF TIME: to set the finish time

Setting the start and finish times

2 During “ON TIME” display

(within 10 seconds or so)

- ① Press [◀◀/–] or [+/▶▶] to select the start time.
- ② Press [CLOCK/TIMER ADJ].

3 During “OFF TIME” display

- ① Press [◀◀/–] or [+/▶▶] to select the finish time.
- ② Press [CLOCK/TIMER ADJ].

The start and finish times are now set.

Turning the timer on

4 Press [TIMER ON/OFF] to display “ⓄPLAY”

The settings are shown in the following order:
 start time → finish time

(The indicator doesn't appear if the clock hasn't been set.)

5 Press [Ⓞ] to turn the unit off.

The unit must be off for the timer to operate.

Play will start in the set condition at the set time with volume increasing gradually to the set level.

To cancel the timer

Press [TIMER ON/OFF] to clear the timer indicator from the display. The timer comes on at the set time everyday if the timer is on.

To change the settings (when the unit is on)

To change the play times

Do steps 1, 2, 3 and 5.

To change the source or volume

1. Press [TIMER ON/OFF] to clear the timer indicator from the display.
2. Make changes to the source or volume.
3. Do steps 4 to 5.

To check the settings (when the unit is off)

Press [CLOCK/TIMER ADJ].

The settings are shown in the following order:

start time → finish time → source → volume → current time

You can enjoy other sources after you have set the timer.

Turn the unit off before the timer's start time.

Note

- If you turn the unit off and on again while a timer is functioning, the finish time setting will not be activated.
- If the unit is on, the timer will not function. The unit must be in the standby mode.
- If AUX is selected as the source, when the timer comes on, the system turns on and engages AUX as the source. If you want to playback from a connected unit, set that unit's timer to the same time. (See the connected unit's instruction manual.)

Using the sleep timer

Remote control only

Set the unit to stop and turn off after a certain time.

While enjoying the desired source:

Press [SLEEP] to select the desired time.

Every time you press the button:

→ SLEEP 30 → SLEEP 60 → SLEEP 90 → SLEEP 120 → OFF →

To cancel the sleep timer

Press [SLEEP] to select “OFF”.

To confirm the remaining time

(only while unit is ON)

Press [SLEEP].

The remaining time is shown for about 5 seconds.

To change the setting

Press [SLEEP] to select the new setting.

Note

The play and sleep timer can be used together.

The sleep timer always has priority. Be sure not to overlap timer settings.

Troubleshooting guide

Before requesting service, make the below checks. If you are in doubt about some of the check points, or if the remedies indicated in the chart do not solve the problem:

In the U.S.A., contact the Panasonic Customer Call Center at 1-800-211-7262, or e-mail consumerproducts@panasonic.com, or web site (<http://www.panasonic.com>).

In Canada, contact Panasonic Canada Inc. Customer Care Centre at 905-624-5505, web site (www.panasonic.ca), or an authorized Servicentre closest to you.

Reference pages are shown as black circled numbers ③.

Common Problems

No sound. Sound stops.	Turn the volume up. Switch off the unit, determine and correct the cause, then switch the unit on. Causes include shorting of the positive and negative speaker wires, straining of the speakers through excessive volume or power, and using the unit in a hot environment.
Sound is unfixd, reversed or comes from one speaker only.	Check the speaker connections. ③
Humming heard during play.	An AC power supply cord or fluorescent light is near the cables. Keep other appliances and cords away from this unit's cables.
"ERROR" is displayed.	Incorrect operation performed. Read the instructions and try again.
"-:-" appears on the display at standby mode.	You plugged the AC adaptor in for the first time or there was a power failure recently. Set the time. ⑩
"F76" is displayed.	There is a power supply problem. Consult the dealer.

Listening to the radio

A beat sound is heard.	Turn the TV off or separate it from the unit.
A low hum or noise is heard during AM broadcasts.	Separate the antenna from other cables and cords. Keep the AM antenna away from the unit.

When there is a television set nearby

The picture on the TV disappears or stripes appear on the screen.	The location and orientation of the antenna are incorrect. The TV antenna wire is too close to the unit. Separate the antenna wire of the TV set from the unit.
---	--

Playing discs

The display is wrong or play won't start.	The disc may be upside down. ⑤ Wipe the disc. Replace the disc if it is scratched, warped, or non-standard. Condensation may have formed inside the unit due to a sudden change in temperature. Wait about an hour for it to clear and try again.
CD-RW cannot be read.	The disc was incompletely formatted. Use the recording equipment to fully format the disc before recording.

Remote control

Remote control doesn't work.	Check that the battery is inserted correctly. ⑤ Replace the battery if it is worn.
------------------------------	---

Maintenance

If the surfaces are dirty

To clean this unit, wipe with a soft, dry cloth.

- Never use alcohol, paint thinner or benzine to clean this unit.
- Before using a chemically treated cloth, read the instructions that came with the cloth carefully.

Limited Warranty (ONLY FOR U.S.A.)

Panasonic Consumer Electronics Company,
Division of Matsushita Electric Corporation of America
One Panasonic Way Secaucus, New Jersey 07094

Panasonic Sales Company, Division of Matsushita Electric
of Puerto Rico, Inc.
Ave. 65 de Infantería, Km. 9.5
San Gabriel Industrial Park, Carolina, Puerto Rico 00985

Panasonic/Technics Audio Products Limited Warranty

Limited Warranty Coverage

If your product does not work properly because of a defect in materials or workmanship, Panasonic Consumer Electronics Company or Panasonic Sales Company (collectively referred to as "the warrantor") will, for the length of the period indicated on the chart below, which starts with the date of original purchase ("warranty period"), at its option either (a) repair your product with new or refurbished parts, or (b) replace it with a new or a refurbished product. The decision to repair or replace will be made by the warrantor.

Product or Part Name	Parts	Labor
Audio Products (except items listed below)	One (1) year	One (1) year
All Audio Racks (cabinets)	Thirty (30) days	Not Applicable
Technics Stand Alone Speakers, Subwoofer Speakers	Three (3) years	Three (3) years
USB Reader-Writer, Personal Computer Card Adapters (in exchange for defective item)	One (1) year	Not Applicable
Accessories: Headphones, Cartridges, Microphones, Adapters	Ninety (90) days	Ninety (90) days
Rechargeable Batteries (in exchange for defective item)	Ten (10) days	Not Applicable
SD Memory Cards, Rechargeable Battery Packs (in exchange for defective item)	Ninety (90) days	Not Applicable

During the "Labor" warranty period there will be no charge for labor. During the "Parts" warranty period, there will be no charge for parts. You must carry-in or mail-in your product during the warranty period. If non-rechargeable batteries are included, they are not warranted. This warranty only applies to products purchased and serviced in the United States or Puerto Rico. This warranty is extended only to the original purchaser of a new product which was not sold "as is". A purchase receipt or other proof of the original purchase date is required for warranty service.

Carry-In or Mail-In Service

For Carry-In or Mail-In Service in the United States call 1-800-211-PANA (1-800-211-7262) or visit Panasonic web site: <http://www.panasonic.com>
For assistance in Puerto Rico call Panasonic Sales Company (787)-750-4300 or fax (787)-768-2910.

Limited Warranty Limits And Exclusions

This warranty ONLY COVERS failures due to defects in materials or workmanship, and DOES NOT COVER normal wear and tear or cosmetic damage. The warranty ALSO DOES NOT COVER damages which occurred in shipment, or failures which are caused by products not supplied by the warrantor, or failures which result from accidents, misuse, abuse, neglect, mishandling, misapplication, alteration, faulty installation, set-up adjustments, misadjustment of consumer controls, improper maintenance, power line surge, lightning damage, modification, or commercial use (such as in a hotel, office, restaurant, or other business), rental use of the product, service by anyone other than a Factory Servicenter or other Authorized Servicer, or damage that is attributable to acts of God.

THERE ARE NO EXPRESS WARRANTIES EXCEPT AS LISTED UNDER "LIMITED WARRANTY COVERAGE". THE WARRANTOR IS NOT LIABLE FOR INCIDENTAL OR CONSEQUENTIAL DAMAGES RESULTING FROM THE USE OF THIS PRODUCT, OR ARISING OUT OF ANY BREACH OF THIS WARRANTY. (As examples, this excludes damages for lost time, travel to and from the servicer, loss of media or images, data or other memory content. The items listed are not exclusive, but are for illustration only.) **ALL EXPRESS AND IMPLIED WARRANTIES, INCLUDING THE WARRANTY OF MERCHANTABILITY, ARE LIMITED TO THE PERIOD OF THE LIMITED WARRANTY.**

Some states do not allow the exclusion or limitation of incidental or consequential damages, or limitations on how long an implied warranty lasts, so the exclusions may not apply to you. This warranty gives you specific legal rights and you may also have other rights which vary from state to state. If a problem with this product develops during or after the warranty period, you may contact your dealer or Servicenter. If the problem is not handled to your satisfaction, then write to the warrantor's Consumer Affairs Department at the addresses listed for the warrantor.

PARTS AND SERVICE WHICH ARE NOT COVERED BY THIS LIMITED WARRANTY ARE YOUR RESPONSIBILITY.

Customer Services Directory (ONLY FOR U.S.A.)

**For Product Information, Operating Assistance, Literature Request, Dealer Locations, and all Customer Service inquiries please contact:
1-800-211-PANA (7262), Monday-Friday 9 am-9 pm; Saturday-Sunday 9 am-7 pm, EST.
or send e-mail:
consumerproducts@panasonic.com
For hearing or speech impaired TTY users, TTY: 1-877-833-8855**

**Web Site: <http://www.panasonic.com>
You can purchase parts, accessories or locate your nearest servicenter by visiting our Web Site.**

Accessory Purchases:

1-800-332-5368 (Customer Orders Only)
For hearing or speech impaired TTY users, TTY: 1-866-605-1277
Panasonic Services Company 20421 84th Avenue South, Kent, WA 98032
(6 am to 5 pm Monday-Friday; 6 am to 10:30 am Saturday; PST)
(Visa, MasterCard, Discover Card, American Express, Check)

**Service in Puerto Rico
Matsushita Electric of Puerto Rico, Inc. Panasonic Sales Company/Factory Servicenter:
Ave. 65 de Infantería, Km. 9.5, San Gabriel Industrial Park, Carolina, Puerto Rico 00985
Phone (787) 750-4300 Fax (787) 768-2910**

Specifications

Radio	
Frequency range	
FM	87.9–107.9 MHz (200 kHz steps) 87.5–108.0 MHz (100 kHz steps)
AM	520–1710 kHz (10 kHz steps)
CD Player	
Sampling frequency	44.1 kHz
Decoding	16 bit linear
Beam source	Semiconductor laser (wavelength 780 nm)
Number of channels	2 channel, stereo
Wow and flutter	Below measurable limit
D/A converter	MASH (1 bit DAC)
General	
Speakers	
Full range	7 cm (2 ³ / ₄ "), 4 Ω x 2
Ceramic tweeter	1.52 cm (1 ⁹ / ₃₂ ") x 2
Jacks	
Output	PHONES: 3.5 mm stereo (32 Ω)
Power requirement	
AC adaptor	DC 10V, 1.2A Power consumption: 18W AC: 120V, 60 Hz 298 x 197 x 141 mm (11 ²³ / ₃₂ " x 7 ³ / ₄ " x 5 ⁹ / ₁₆ "
Dimensions (WxHxD)	
Mass	
With speakers	2.7 kg (5 lb. 15 oz.)
Without speakers	1.5 kg (3 lb. 5 oz.)

Power consumption in standby mode: 1.3 W

Note

Specifications are subject to change without notice.
Mass and dimensions are approximate.

Product Service

- 1. Damage requiring service**—The unit should be serviced by qualified service personnel if:
 - (a) The AC power supply cord or AC adaptor has been damaged; or
 - (b) Objects or liquids have gotten into the unit; or
 - (c) The unit has been exposed to rain; or
 - (d) The unit does not operate normally or exhibits a marked change in performance; or
 - (e) The unit has been dropped or the cabinet damaged.
- 2. Servicing**—Do not attempt to service the unit beyond that described in these operating instructions. Refer all other servicing to authorized servicing personnel.
- 3. Replacement parts**—When parts need replacing ensure the servicer uses parts specified by the manufacturer or parts that have the same characteristics as the original parts. Unauthorized substitutes may result in fire, electric shock, or other hazards.
- 4. Safety check**—After repairs or service, ask the servicer to perform safety checks to confirm that the unit is in proper working condition.

Product information

For product information or assistance with product operation:

In the U.S.A., contact the Panasonic Customer Call Center at 1-800-211-7262, or e-mail consumerproducts@panasonic.com, or web site (<http://www.panasonic.com>).

In Canada, contact Panasonic Canada Inc. Customer Care Centre at 905-624-5505, web site (www.panasonic.ca), or an authorized Servicentre closest to you.

**Panasonic Consumer Electronics
Company, Division of Matsushita
Electric Corporation of America**

One Panasonic Way Secaucus,
New Jersey 07094

<http://www.panasonic.com>

©2003 Matsushita Electric Industrial Co., Ltd.
Printed in China

**Panasonic Sales Company,
Division of Matsushita Electric of
Puerto Rico, Inc. ("PSC")**

Ave. 65 de Infantería, Km. 9.5
San Gabriel Industrial Park, Carolina,
Puerto Rico 00985

Panasonic Canada Inc.

5770 Ambler Drive
Mississauga, Ontario
L4W 2T3

www.panasonic.ca



RQT6734-1P

G0103CP1023